

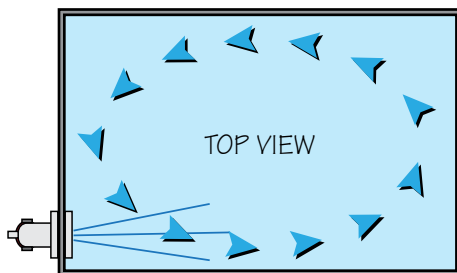

The Power-Jet aerator is designed to be mounted well below the surface of the livewell for direct introduction of fresh oxygenated water. It can be used with systems 2, 3, or 4, or a livewell mounted aerator pump only. (It is not for use with a transom mounted pump.) Includes a special air intake fitting with gasket and nut.

### Remote Venturi Intake

Venturi air intake has many mounting options and can be mounted anywhere above water level. Shown here with optional domed decal.

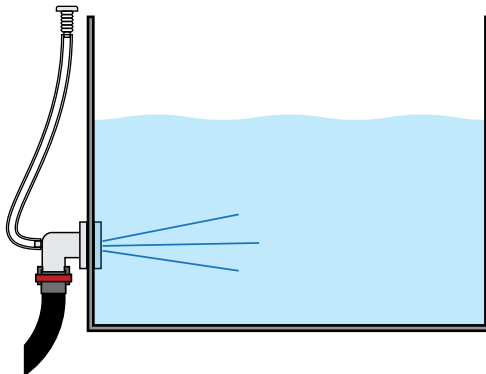

### Air Intake Tubing

Easily routed and may be cut to length to suit specific needs.

### Discharge Nozzle

Should be mounted near a corner to promote livewell water circulation.



# Power-Jet Aerator

# PJA

## Air Intake Mounting Options

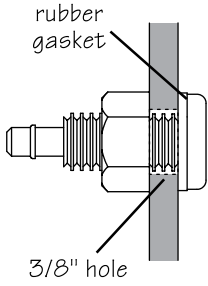

### Mounting air intake without decal

Drill a 3/8" hole in a location well above the highest water line of the livewell in an area that allows the routing of the air intake tubing. Insert air intake with rubber gasket. Use a 3/16" allen wrench in air intake head while tightening nut on back side of tank wall. Push air hose onto air intake.

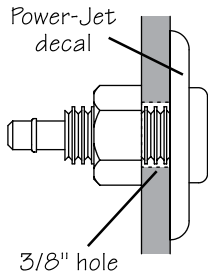

### Mounting air intake with decal

Pick a location well above the highest water line of the livewell in an area that allows the routing of the air intake tubing. This is usually an area along the vertical rise of the gunnel. Drill a 3/8" hole, deburr and clean surrounding area with alcohol. Mount the air intake fitting to a 3/16" allen wrench. Carefully remove decal from protective backing and insert intake fitting through center hole.

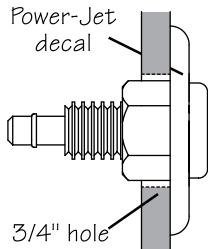

### Mounting air intake when there is no access to back of mounting surface

Pick a location well above the highest water line of the livewell in an area that allows the routing of the air intake tubing. This is usually an area along the vertical rise of the gunnel. Drill a 3/4" hole, deburr and clean surrounding area with alcohol. Route tubing from aerator leaving a few inches of excess tubing out hole. Mount the air intake fitting to a 3/16" allen wrench. Carefully remove decal from protective backing and insert intake fitting through center hole. Install mounting nut. Install air intake tubing to air intake fitting. Orient the text properly and push assembly into 3/4" mounting hole. When decal is firmly bonded to surface, remove allen wrench.



DCL-PJ1-W DCL-PJ1-G

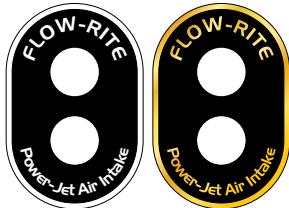

DCL-PJ2-W DCL-PJ2-G

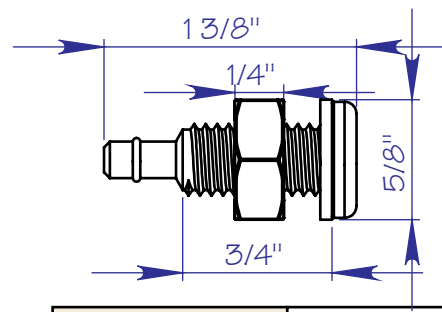
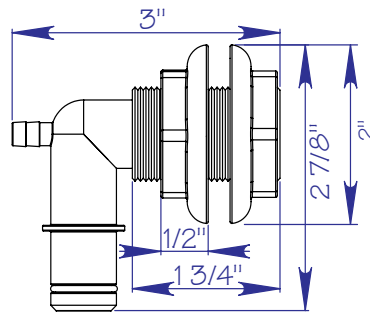

	Qwik-Lok Part #	Barbed Part #
PJA w/Air Intake Assy, (No decal, no air tubing)	MH-PJA-200	MH-PJA-100
PJA w/Air Intake Assy & 20" Air tubing, (no decal)	MH-PJA-220	MH-PJA-120
PJA w/Air Intake Assy w/60" Air tubing & Decal w/ White lettering	MA-1043	MA-1044
PJA w/Air Intake Assy w/60" Air tubing & Decal w/ Gold lettering	MA-1045	MA-1046
Air Tubing, 3/16" I.D., Sold by foot	MD-055	
Domed Decal, Single White lettering	LBL-PJ1-W	
Domed Decal, Single Gold lettering	LBL-PJ1-G	
Domed Decal, Double White lettering	LBL-PJ2-W	
Domed Decal, Double Gold lettering	LBL-PJ2-G	