

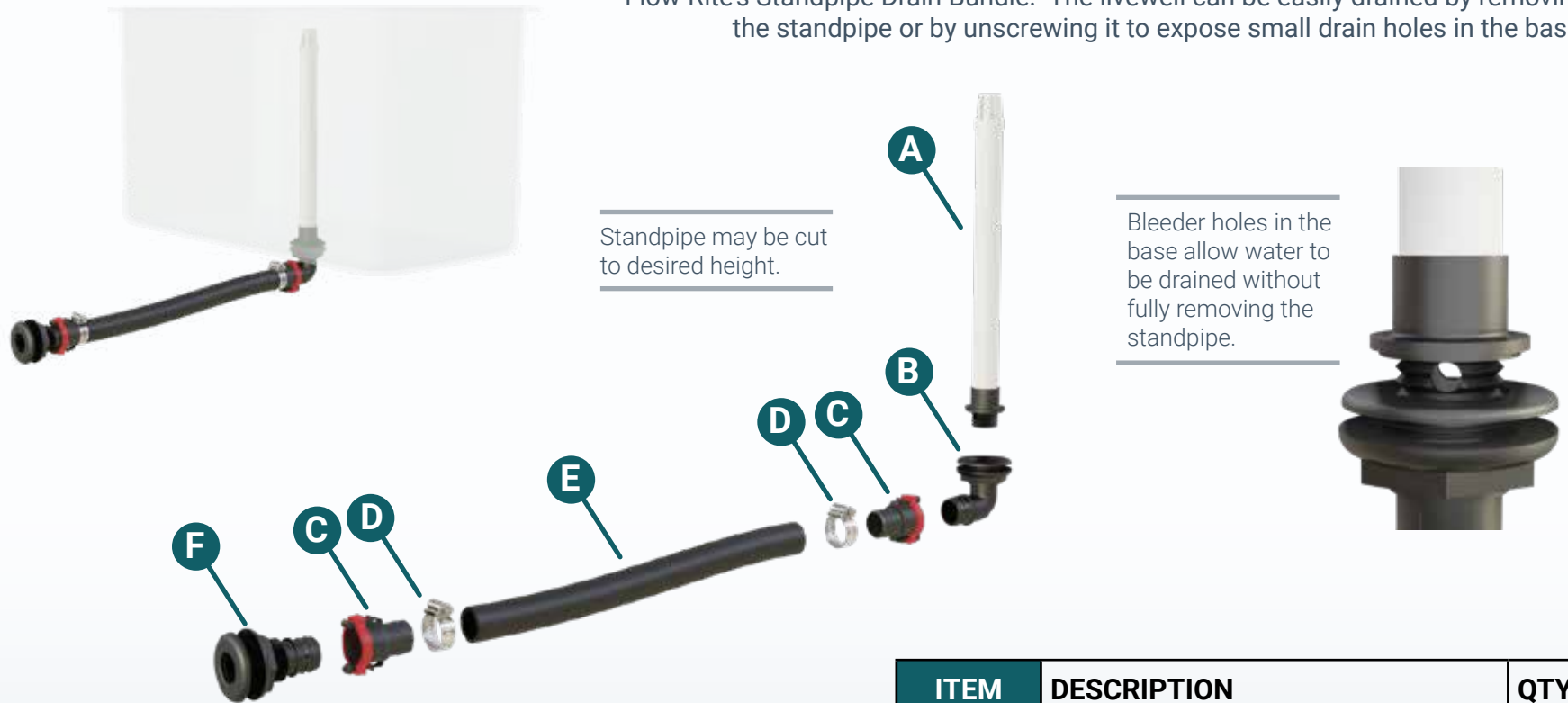

STANDPIPE DRAIN BUNDLE

1-1/8" Qwik-Lok™, MB-001

Keep your fish healthy and maintain a consistent water level in your livewell with Flow-Rite's Standpipe Drain Bundle. The livewell can be easily drained by removing the standpipe or by unscrewing it to expose small drain holes in the base.



INSTALLATION TIPS:

- Standpipe may be cut to desired height using a PVC cutting tool.
- Secure all fittings. Marine sealant may be used with thru-hull fittings.
- Once assembled, slide Qwik-Lok locking ring forward, into the locked position.
- Cut hose to desired length.

ITEM	DESCRIPTION	QTY
A	12" Standpipe	1
B	1-1/8" Thru-hull, elbow	1
C	Qwik-Lok socket, straight	2
D	Hose Clamp	2
E	6 feet of 1-1/8" Hose	1
F	1-1/8" thru-hull, straight	1



3/4" BILGE BUNDLE

3/4" Qwik-Lok™, MB-002

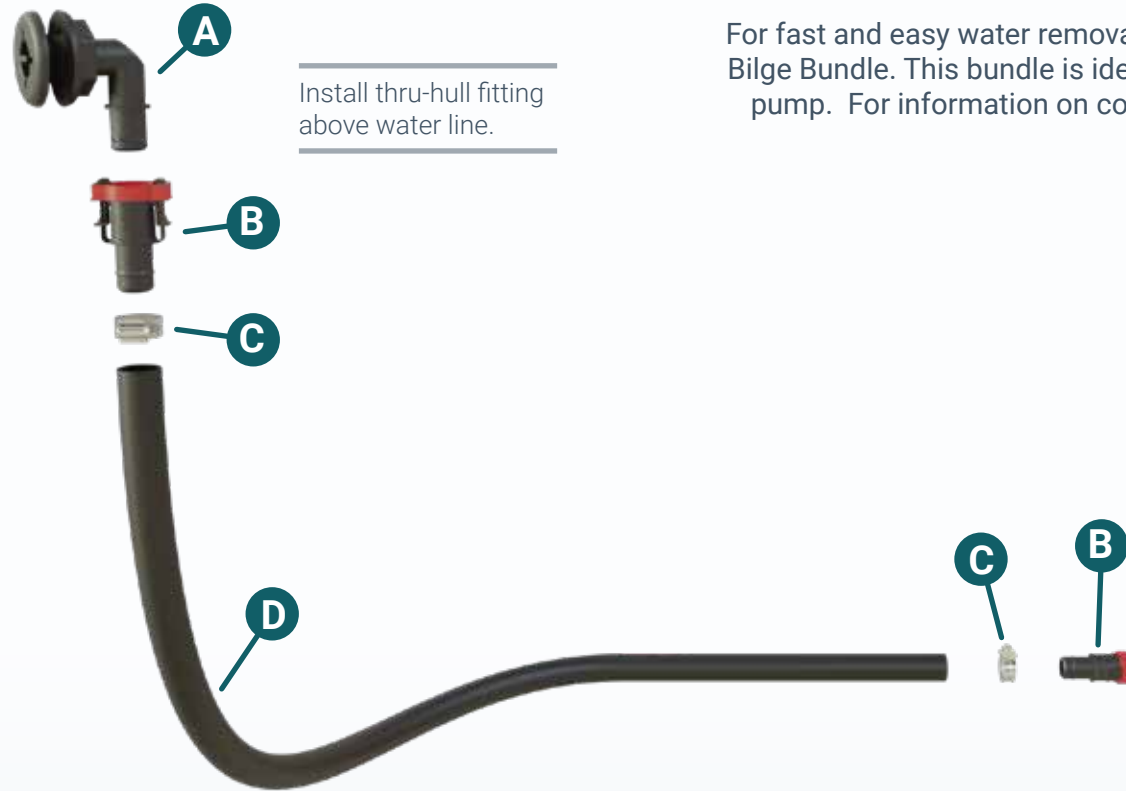

Install thru-hull fitting above water line.

For fast and easy water removal from your bilge area, rely on Flow-Rite's 3/4" Bilge Bundle. This bundle is ideal for boating enthusiasts who already have a pump. For information on compatible Qwik-Lok pumps, visit flow-rite.com.



Qwik-Lok socket used with Qwik-Lok pumps only (not included). For pumps that are not Qwik-Lok, use hose clamp only.

INSTALLATION TIPS:

- Connect hose to pump with Qwik-Lok socket and/or clamp.
- Install thru-hull fitting above water line.
- Secure all fittings. Marine sealant may be used with thru-hull fitting.
- Once assembled, slide Qwik-Lok locking ring forward, into the locked position.
- Cut hose to desired length.

ITEM	DESCRIPTION	QTY
A	Thru-hull, 3/4" elbow	1
B	Qwik-Lok socket, straight, 3/4"	2
C	Clamp	2
D	6' of Hose, 3/4"	1



3/4" BILGE BUNDLE WITH PUMP

3/4" Qwik-Lok™, MB-003

Flow-Rite's 3/4" Bilge Bundle features a 1000 GPH pump for removing water from your bilge area. This comprehensive bundle takes the guesswork out of water removal and provides worry-free operation.

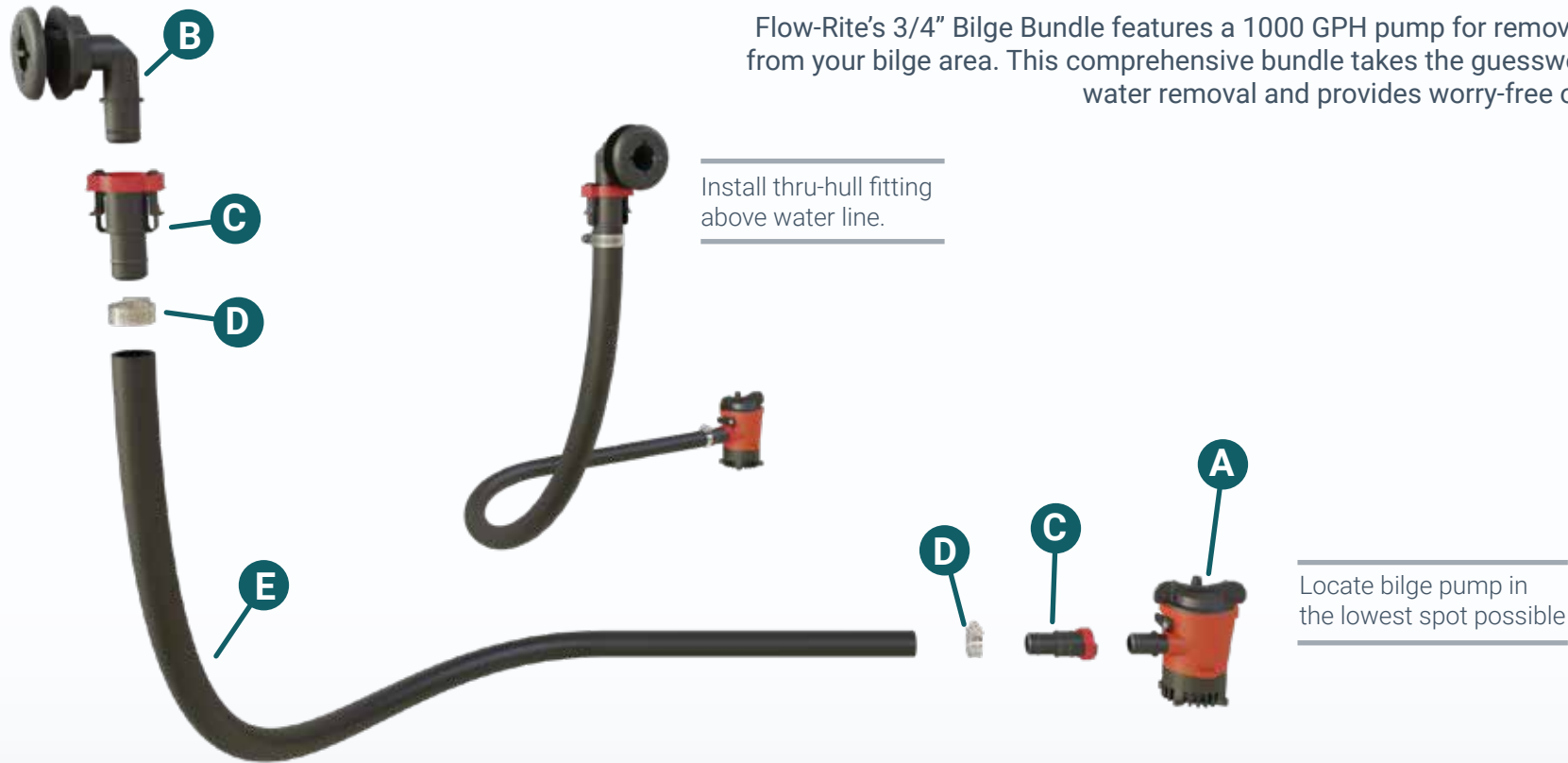

INSTALLATION TIPS:

- Locate bilge pump in the lowest possible location of the bilge area.
- Install thru-hull fitting above water line.
- Secure all fittings. Marine sealant may be used with thru-hull fitting.
- Once assembled, slide Qwik-Lok locking ring forward, into the locked position.
- Cut hose to desired length.

ITEM	DESCRIPTION	QTY
A	Bilge pump, Johnson, 1000 GPH	1
B	Thru-hull, 3/4" elbow	1
C	Qwik-Lok socket, straight, 3/4"	2
D	Hose Clamp	2
E	6' of Hose, 3/4"	1



1-1/8" BILGE BUNDLE

1-1/8" Qwik-Lok™, MB-004

This bundle is ideal for boat owners who already have their own bilge pump. Quickly install this bundle and you'll be able to remove water from your bilge area in no time. If you need a pump, visit flow-rite.com for more information.

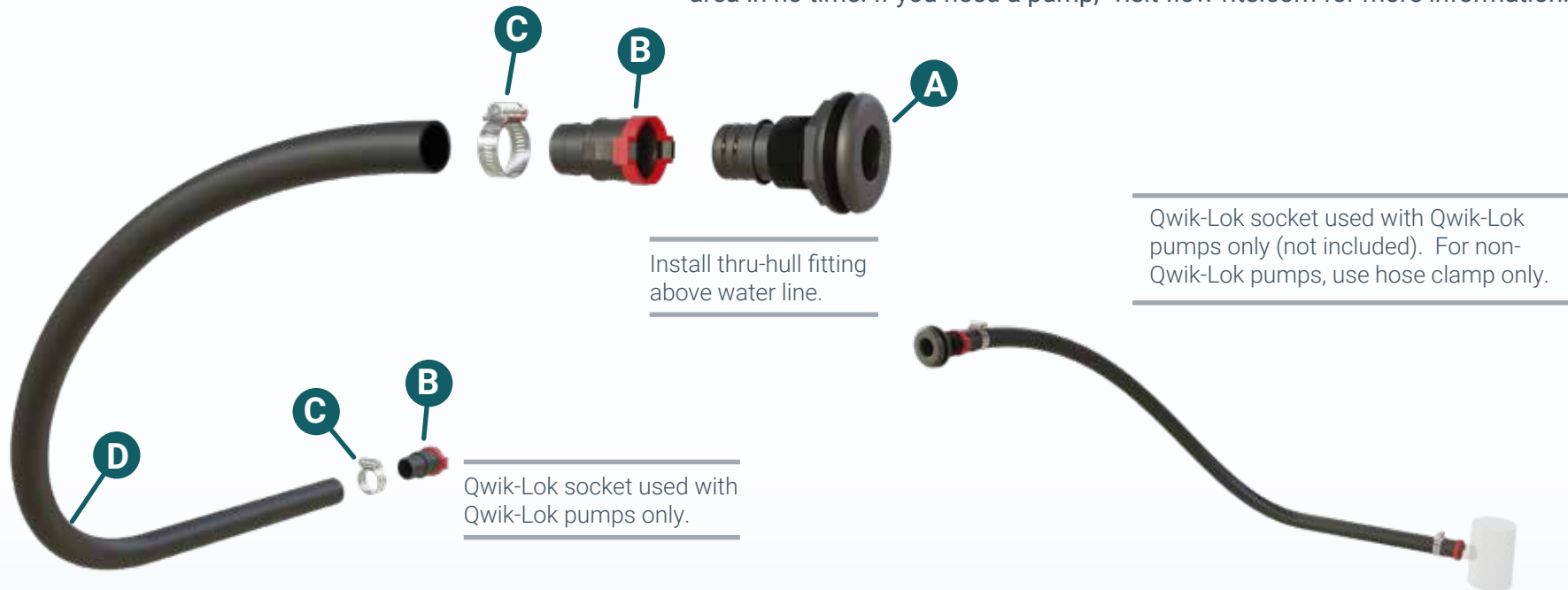

INSTALLATION TIPS:

- Connect hose to pump with Qwik-Lok socket and/or clamp.
- Install thru-hull fitting above water line.
- Secure all fittings. Marine sealant may be used with thru-hull fitting.
- Once assembled, slide Qwik-Lok locking ring forward, into the locked position.
- Cut hose to desired length.

ITEM	DESCRIPTION	QTY
A	Thru-hull, straight, 1-1/8"	1
B	Qwik-Lok socket, straight, 1-1/8"	2
C	Hose Clamp	2
D	6' of Hose, 1-1/8"	1



1-1/8" BILGE BUNDLE WITH PUMP

1-1/8" Qwik-Lok™, MB-005

Quickly install this Bilge bundle which comes with a handy 1000 GPH pump. It includes everything you need to remove water from your bilge area.



Install thru-hull fitting above water line.

Locate bilge pump in the lowest spot possible

INSTALLATION TIPS:

- Locate bilge pump in the lowest possible location of the bilge area.
- Install thru-hull fitting above water line.
- Secure all fittings. Marine sealant may be used with thru-hull fitting.
- Once assembled, slide Qwik-Lok locking ring forward, into the locked position.
- Cut hose to desired length.

ITEM	DESCRIPTION	QTY
A	Bilge pump, Rule, 1000 GPH	1
B	Thru-hull, straight, 1-1/8"	1
C	Qwik-Lok socket, straight, 1-1/8"	2
D	Hose Clamp	2
E	6' of Hose, 1-1/8"	1



PUMP-OUT AERATOR BUNDLE

3/4" Qwik-Lok™, MB-006

Convert your existing recirculation pump into a PowerStream Pump-Out Aerator Combo with this bundle. By simply pulling the red aerator head, water is diverted from the livewell to the Included pump-out thru-hull.

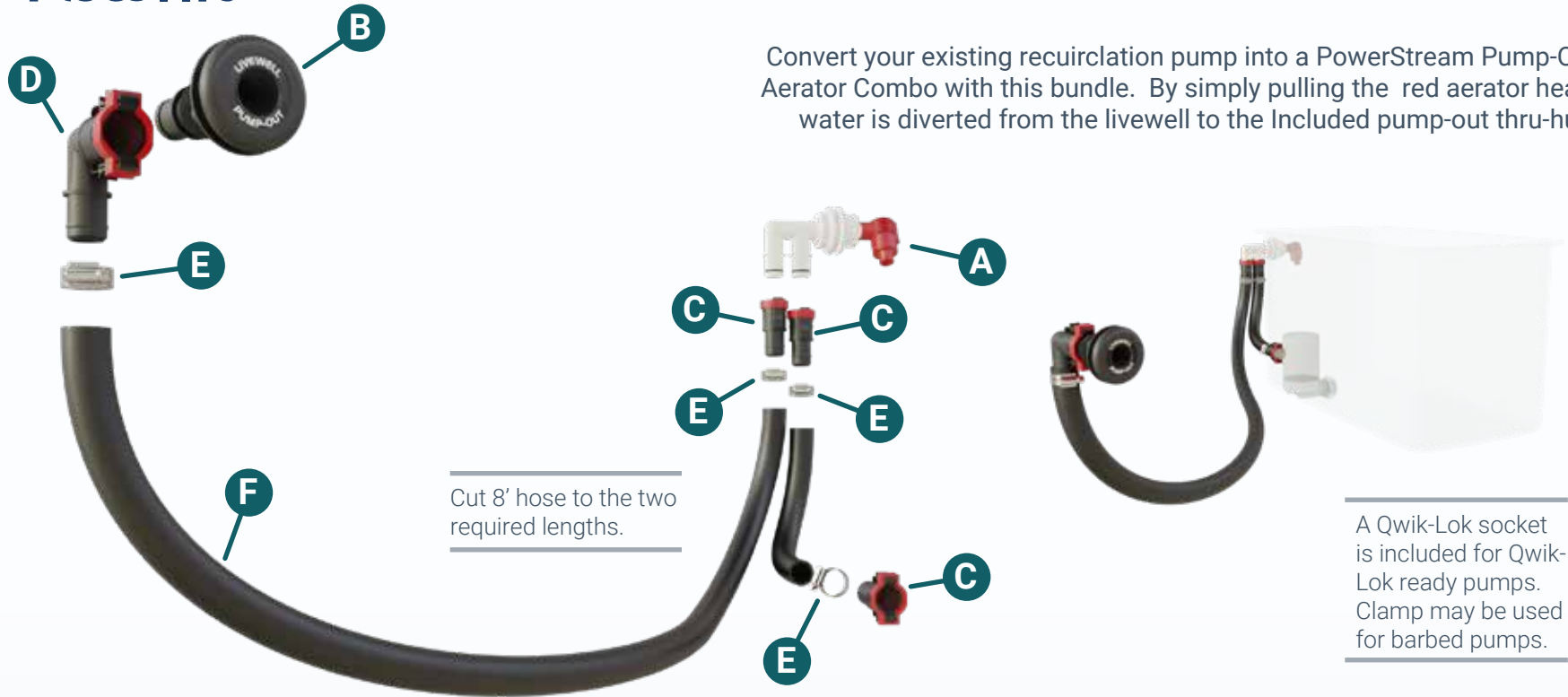

Cut 8' hose to the two required lengths.

A Qwik-Lok socket is included for Qwik-Lok ready pumps. Clamp may be used for barbed pumps.

INSTALLATION TIPS:

- Pump-out aerator must be used with a recirculating pump or system.
- Thru-hull may be mounted above water line and may be used for filling tournament bags.
- Secure all fittings. Marine sealant may be used with thru-hull and aerator fittings.
- Once assembled, slide Qwik-Lok locking ring forward, into the locked position.
- Cut hose to desired lengths.

ITEM	DESCRIPTION	QTY
A	Pump-out aerator	1
B	Pump-out thru-hull	1
C	Qwik-Lok socket, 3/4", straight	3
D	Qwik-Lok socket, 3/4", elbow	1
E	Hose Clamp	4
F	3/4" Hose, 8 feet	1